

SHORING POLES

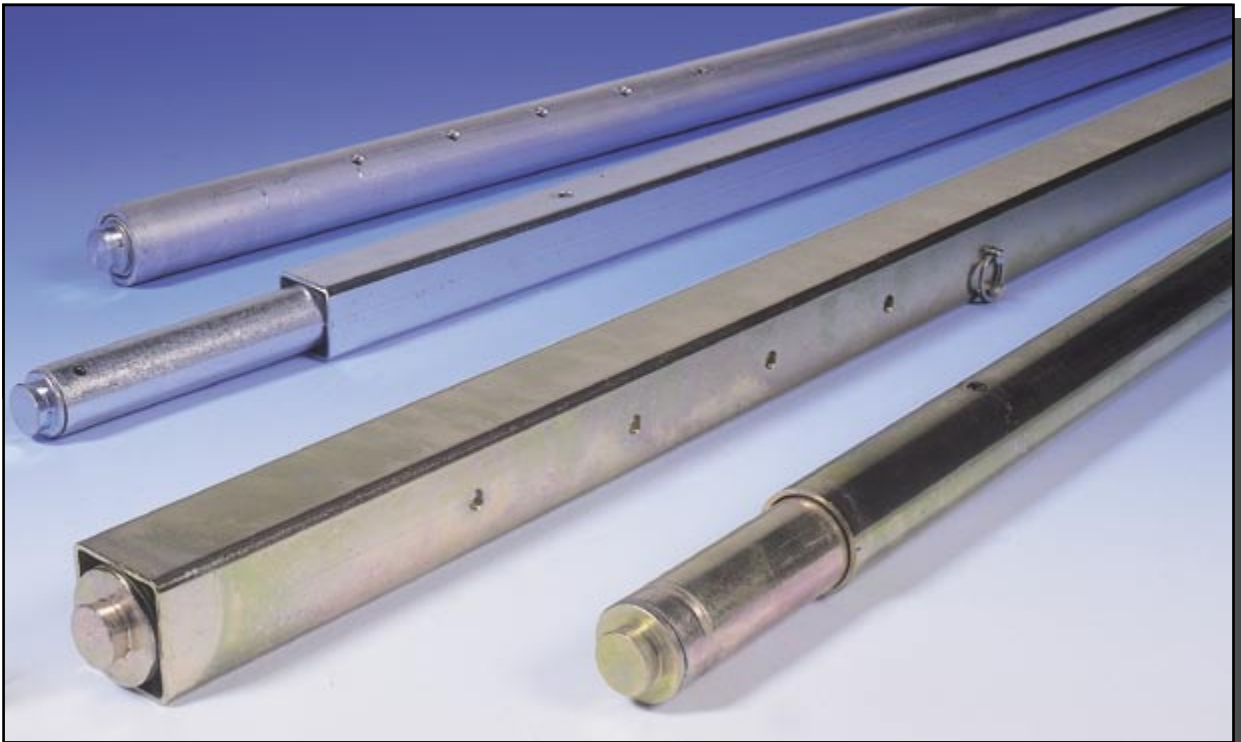

See page 2.4 for end fittings

TELESCOPIC SHORING POLES, round section, adjustable



Art.nr.	Suitable for track-to-track	Diam. in mm	Min/Max Length	Material	Load Capacity*	Weight
1808AL	2250 - 2650 mm	Ø 45	2320-2665	Aluminium	ca. 375 kg	5 kg
1809AL	2750 - 3150 mm	Ø 45	2825-3160	Aluminium	ca. 350 kg	6 kg
1811	2000 - 2400 mm	Ø 45	2085-2485	Steel & Zinc plated	ca. 450 kg	9 ⁵ kg
1811EL	2360 - 2760 mm	Ø 45	2445-2845	Steel & Zinc plated	ca. 450 kg	10 kg
1811304	2000 - 2400 mm	Ø 45	2085-2485	Stainless Steel 304	ca. 450 kg	9 ⁵ kg
1811EL304	2360 - 2760 mm	Ø 45	2445-2845	Stainless Steel 304	ca. 450 kg	10 kg

TELESCOPIC SHORING POLES, square, adjustable



Art.nr.	Suitable for track-to-track	Main Tube in mm	Min/Max Length	Material	Load Capacity*	Weight
1812	2250 - 2650 mm	∇ 40	2345-2680	Steel & Zinc plated	ca. 400 kg	8 ⁵ kg
1812HD	2250 - 2650 mm	∇ 50	2345-2680	Steel & Zinc plated	ca. 675 kg	10 ¹ kg

*Load Capacity assumes weight evenly distributed





CARGO RESTRAINT SYSTEMS

SHORING POLES

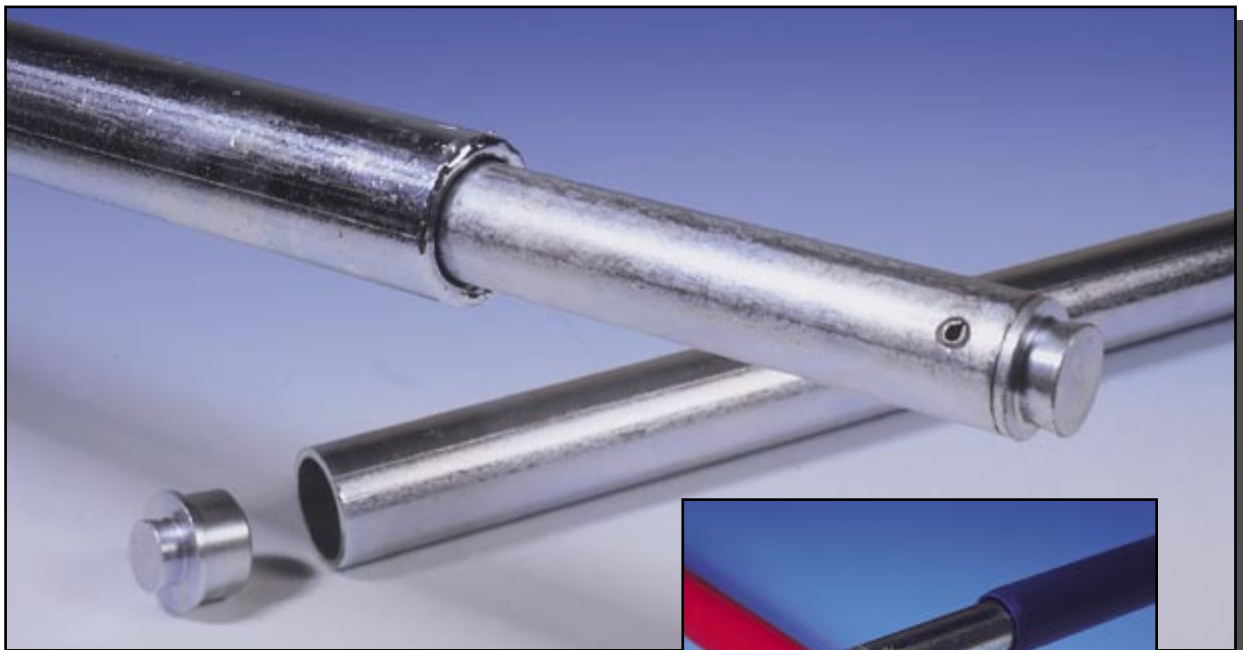

See page 2.4 for end fittings



Also available with high performance thermoplastic elastomer cover.

TELESCOPIC SHORING POLES



Art.nr.	Suitable for track-to-track	Diam. in mm	Max Length	Material	Load Capacity*	Gewicht
1813	2000 - 2100 mm	Ø 42	2135 mm	Steel & Zinc plated	400 kg	7 ⁵ kg
1814	2100 - 2200 mm	Ø 42	2235 mm	Steel & Zinc plated	390 kg	7 ⁵ kg
1815	2200 - 2300 mm	Ø 42	2335 mm	Steel & Zinc plated	390 kg	7 ⁵ kg
1816	2300 - 2400 mm	Ø 42	2435 mm	Steel & Zinc plated	380 kg	8 kg
1818	2380 - 2480 mm	Ø 42	2505 mm	Steel & Zinc plated	380 kg	8 kg
1818EL	2460 - 2560 mm	Ø 42	2590 mm	Steel & Zinc plated	375 kg	8 kg

TELESCOPIC SHORTENABLE SHORING POLES, with loose end plug, customer cuts to required length



Art.nr.	Suitable for track-to-track	Diam. mm	Max Length	Material	Load Capacity*	Weight
1818ELSPEC	max 2560 mm	Ø 42	2590 mm	Steel & Zinc plated	± 375 kg	8 kg
1819	max 3100 mm	Ø 42	3150 mm	Steel & Zinc plated	± 350 kg	10 kg
2818	max 2500 mm	Ø 35	2568 mm	Steel & Zinc plated	± 450 kg	5 ⁵ kg
2819	max 2950 mm	Ø 35	3000 mm	Steel & Zinc plated	± 450 kg	6 kg

*) Load Capacity assumes weight evenly distributed



SHORING POLES



See page 2.4 for end fittings

SHORING POLE FOR ROLL-CONTAINERS,
shortenable with loose plug, customer cuts to required length



Art.nr.	Suitable for track-to-track	Diam. in mm	Max Length	Material	Load Capacity*	Gewicht
1810	max 2950 mm	Ø 42	3000 mm	Steel & Zinc plated	± 300 kg	10 kg
2810 (=1810HD)	max 3200 mm	Ø 35	3300 mm	Steel & Zinc plated	± 450 kg	6 ⁵ kg

*Load capacity assumes weight evenly distributed.

securing the roll container:

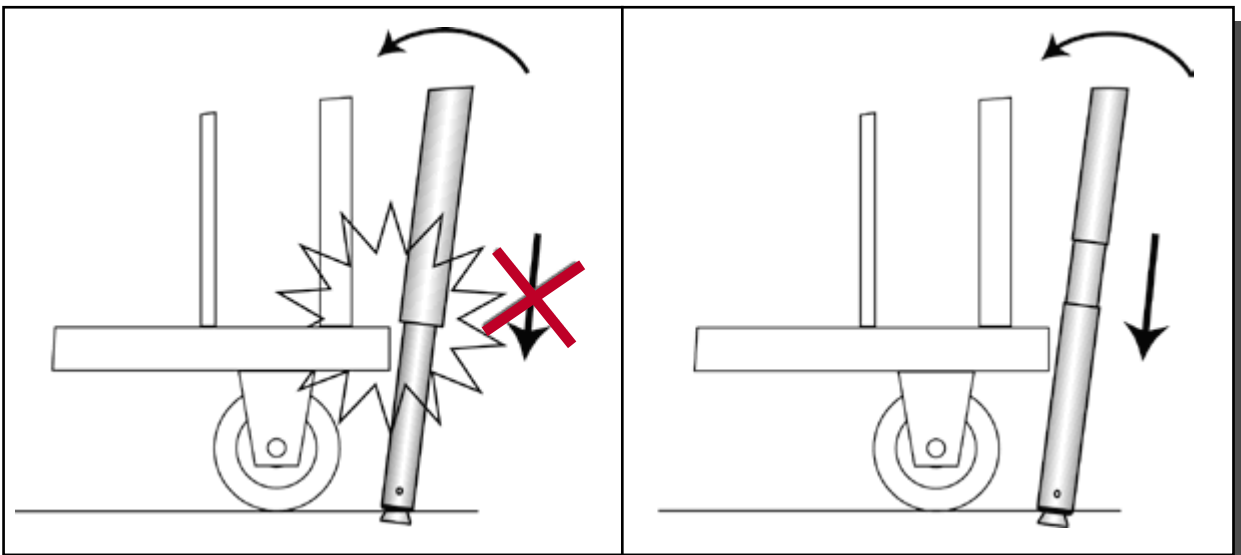

SHORING POLES

END FITTINGS, HAND GRIPS & 'DOG LEAD' SYSTEM

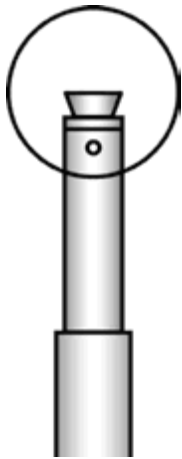

Conical End Plug
20 mm

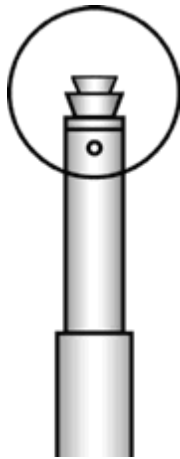

20/25mm Dual Purpose End Plug

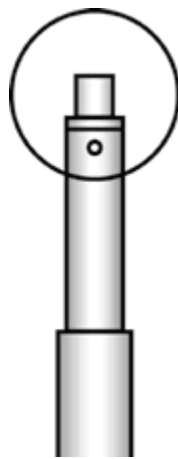

Cylindrical Plug

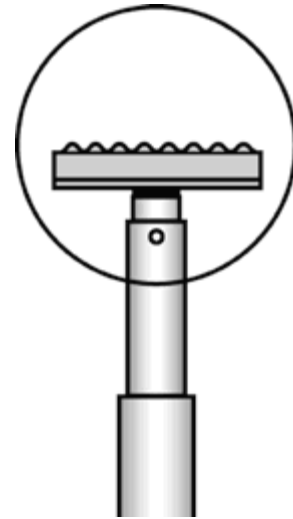

Kargo Keeper Foot

Note: Shoring poles will be fitted with a standard 25mm dia end plug unless otherwise specified from the above selection.

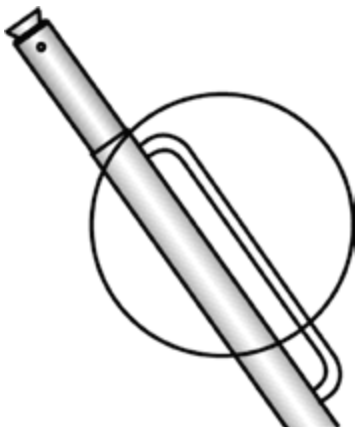

U-Handgrip

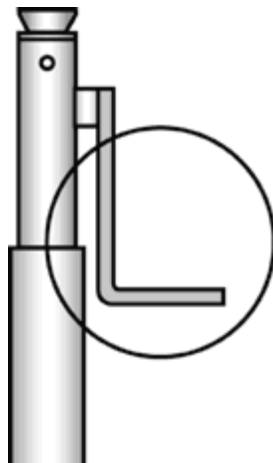

L-Handgrip

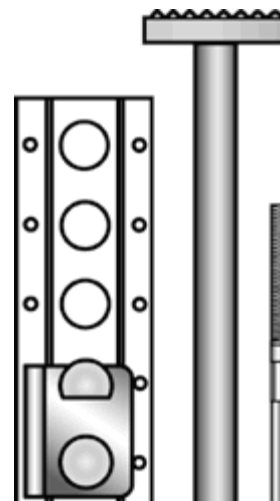

Shoring Pole 'Dog Lead' System – Horizontal Mounting & not as shown. Please ask for further information.

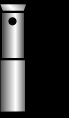

SHORING POLES

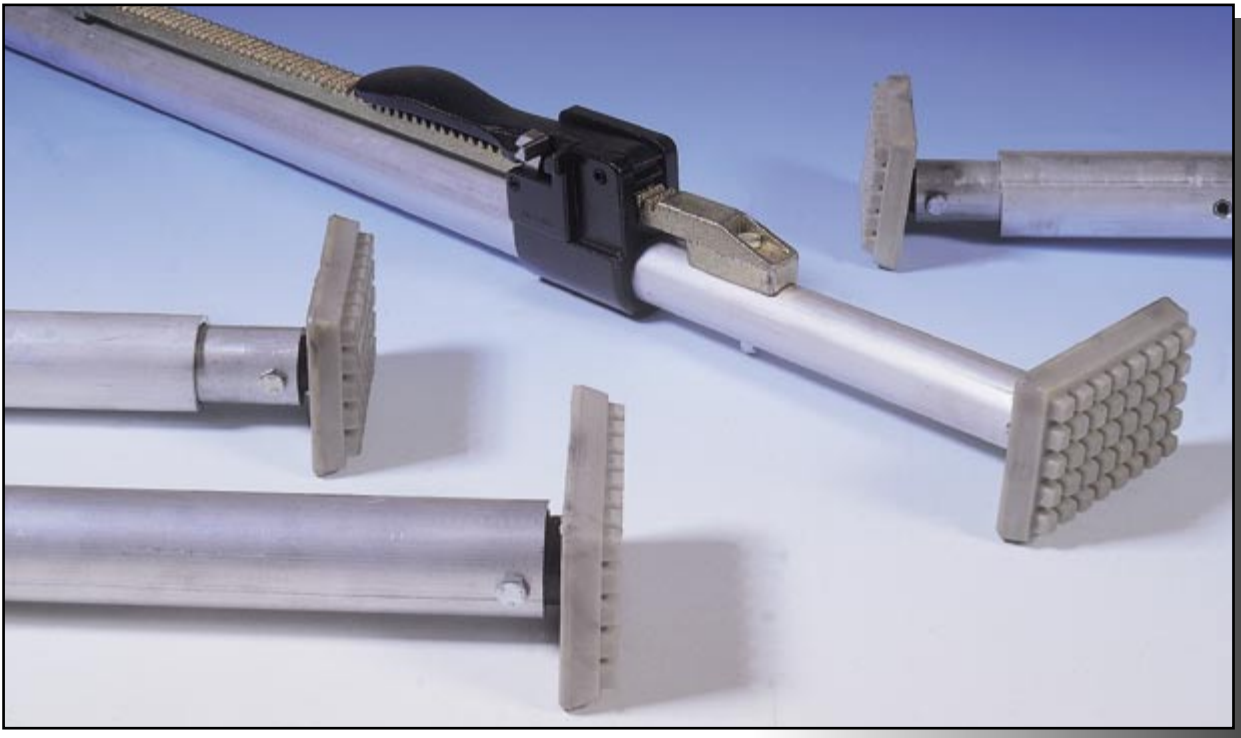

The Load-Lok standard, extra long (EL) and heavy duty (HD) Kargo Keepers are designed for cargo shoring without using cargo restraint track. The ratchet mechanism expands the Kargo Keeper clamping itself between and directly onto the trailer walls or floor and roof. Its large pressure absorbent feet grip firmly whilst also distributing the load. The non-extending end is available in a fixed or spring loaded (WS) version. The spring end version can compensate for an amount of flexing that might occur in some trailer walls. Kargo Keeper can also be supplied track compatible.

KARGO KEEPER



Art.nr.	Suitable for wall-to-wall in mm*	Diameter	Material	Weight
1867	2240 - 2630	Ø 38 mm	Aluminium	4 kg

KARGO KEEPER, with spring



Art.nr.	Suitable for wall-to-wall in mm*	Diameter	Material	Weight
1867WS	2275 - 2665	Ø 38 mm	Aluminium	4 kg
1867WSEL	2575 - 2965	Ø 38 mm	Aluminium	4 ⁵ kg
1867HDWS	2275 - 2665	Ø 42 mm	Aluminium	5 ³ kg
1867HDWSEL	2575 - 2965	Ø 42 mm	Aluminium	5 ⁸ kg

*) Also other dimension ranges available on request.





CARGO RESTRAINT SYSTEMS

SHORING POLES

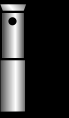
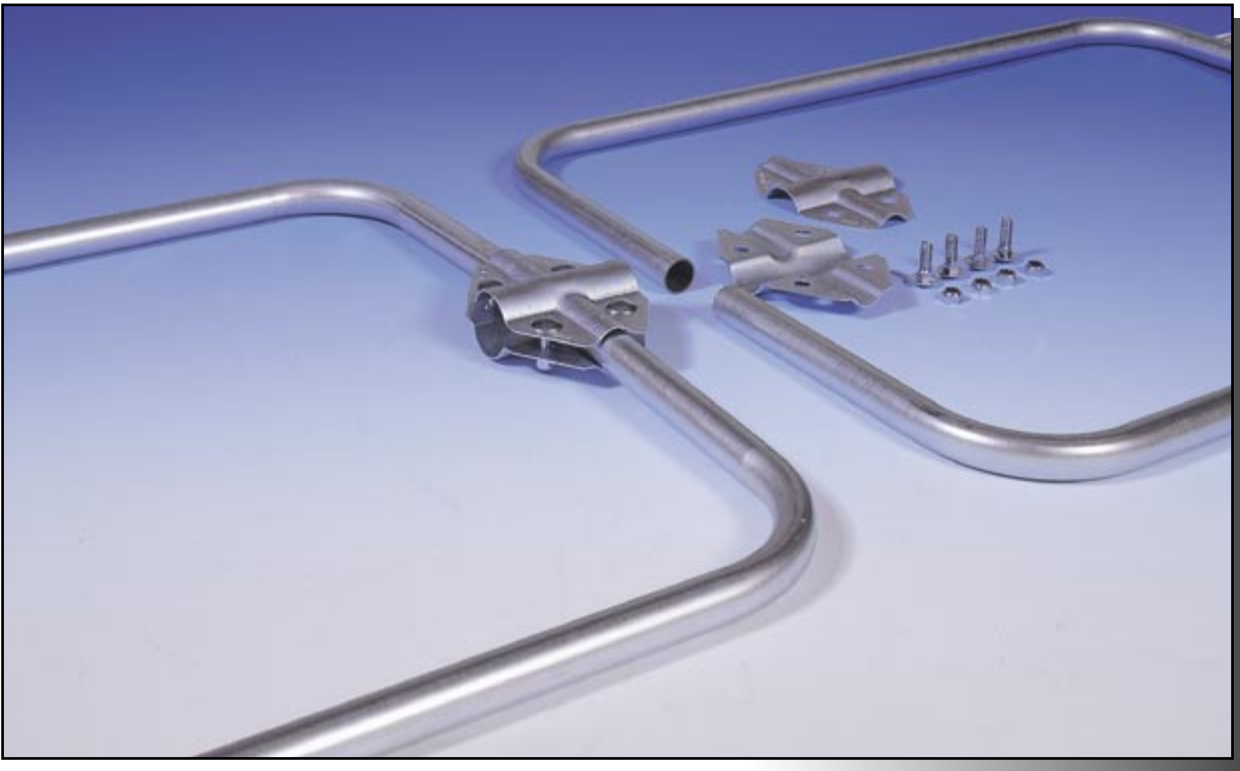

HOOPS

for KARGO-KEEPERS/CARGO-BARS or TELESCOPIC SHORING POLES

To increase the load barring area. This easy to assemble kit is available for Kargo-Keeper / Cargo-Bar (bar diameter $\varnothing 38$ mm) as well as for telescopic shoring poles ((bar diameter $\varnothing 42$ mm).

HOOP SET

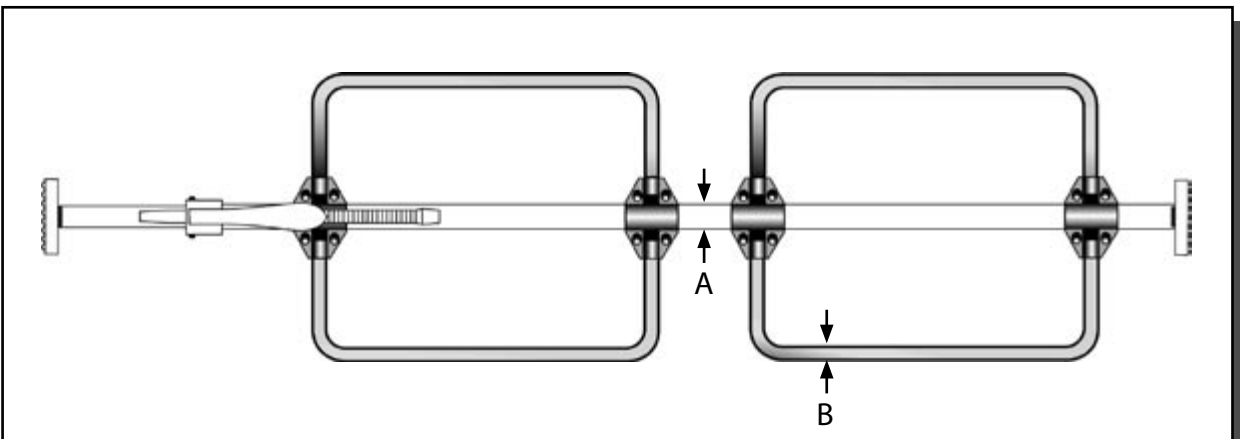

Art.nr.	Suitable for	Bar \varnothing (A)	Hoop dimension in mm			Material	Weight
			H	B	\varnothing (B)		
1867HP	Kargo-Keeper/ Cargo-Bar	38 mm	600	740	$\varnothing 25$	Steel & Zinc plated	6 kg
1867HP42	Telescopic Shoring Poles	42 mm	600	740	$\varnothing 25$	Steel & Zinc plated	6 kg

SHORING POLES

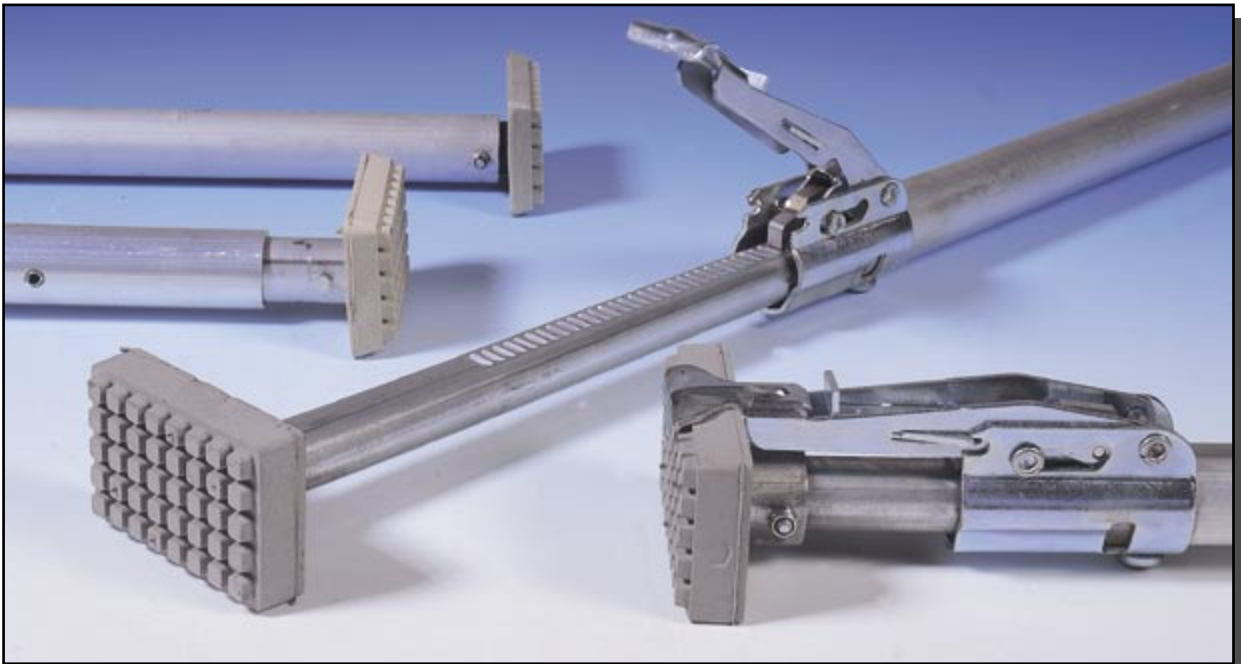

Load-Lok standard, extra long (EL) and steel (ST) Cargo Bars are designed for cargo shoring without using cargo restraint track. The patented ratchet mechanism allows the Cargo Bar to be positioned securely before conducting the final ratchet operation. The ratchet mechanism expands the Cargo Bar clamping itself between and directly on to the trailer walls or floor and roof. Its large pressure absorbent feet grip firmly whilst also distributing the load. The non-extending end is available in a fixed or spring loaded (WS) version. The spring end version can compensate for an amount of flexing that might occur in some trailer walls. Cargo Bar can also be supplied track compatible.

Cargo Bars are not a stock item and only available by special order.

CARGO-BAR



Art.nr.	Diameter	Material	Suitable for wall-to-wall	Weight
FE 804060	Ø 38 mm	Aluminium/Steel	2200-2600 mm	4 ² kg
FE 804060EL	Ø 38 mm	Aluminium/Steel	2600-3000 mm	4 ⁹ kg

CARGO-BAR, with spring



Art.nr.	Diameter	Material	Suitable for wall-to-wall	Weight
FE 804060WS	Ø 38 mm	Aluminium/Steel	2200-2600 mm	4 ³ kg
FE 804060WSEL	Ø 38 mm	Aluminium/Steel	2600-3000 mm	5 kg
FE 804060STWS	Ø 38 mm	Steel/Steel	2200-2600 mm	6 ⁷ kg



SHORING POLES



Load-Lok Heavy Duty expandable shoring poles.

GOLDBAR, steel, round, with spring

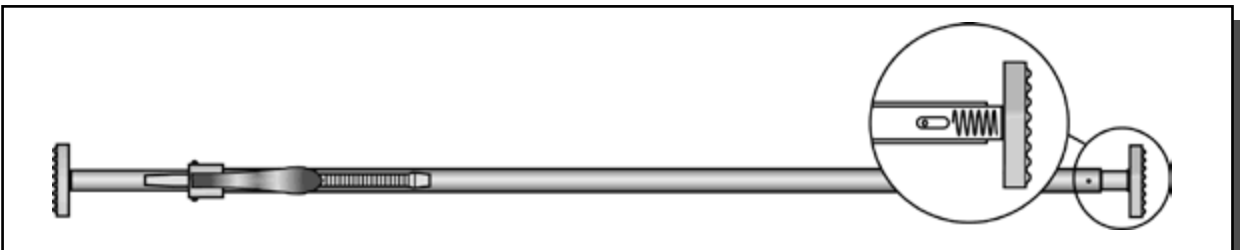

Art.nr.	Main Tube Diameter	Material	Suitable for wall-to-wall	Weight
1867STWS	Ø 38 mm	Steel & Zinc plated	2275-2665 mm	6 ⁵ kg

CARGO-FIX, with spring



Art.nr.	Main Tube	Material	Suitable for wall-to-wall	Load Capacity*	Weight
1869ST	∇ 40 mm	Steel & Zinc plated	2150-3100 mm	± 600 kg	8 kg

*Load capacity assumes weight evenly distributed.



SHORING POLES



Cart-Lock for quick and easy securing of roll pallets. Compatible with Load-Lok tracks 3008/3009/2010.

CART-LOCK

FE-809021

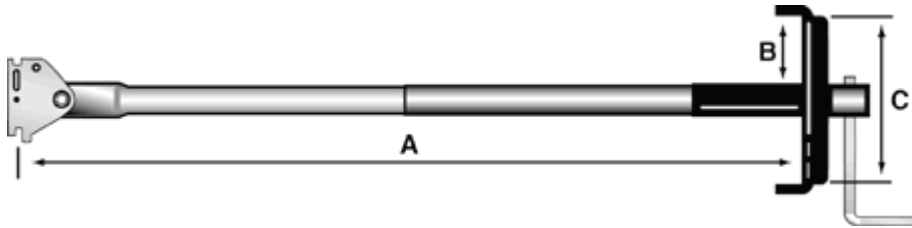

FE-809041

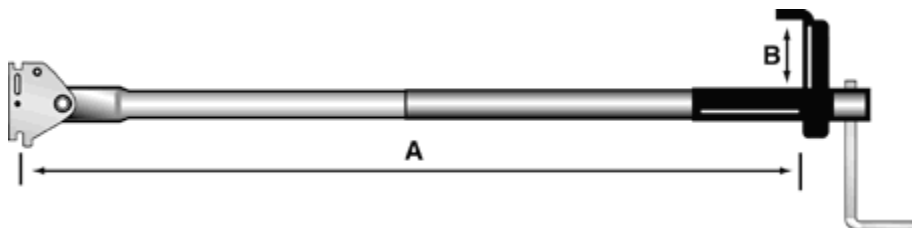

Art.nr.	Dimension in mm				Load Capacity*	Material tube/clamp	Weight
	A min	A max	B	C			
FE 809021	610	838	46	120	540 kg	painting steel/plastic coated	1 ⁸ kg
FE 809041	610	838	46	-	540 kg	painting steel/plastic coated	1 ⁸ kg

*Load capacity assumes weight evenly distributed.



CARGO RESTRAINT SYSTEMS

SHORING POLES



The Load-Lok Cargo Plank is suited for use in tilt trailers and some curtain siders where side boards are fitted. Cargo Plank clips easily to the vehicle side boards and offers quick and efficient cargo shoring where none previously was possible. For light loads the 1852 Plankcup can offer an economic solution to cargo shoring.

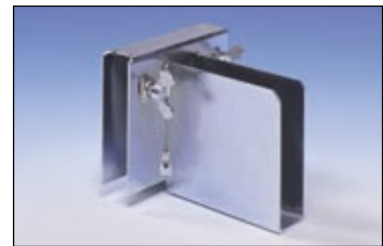

'Economy' plankcup 1852

CARGO PLANK

1850		adjustable		
1851		fixed length		
Art.nr.	Plank dimensions	Material	Working Length	Weight
1850	125 x 30 mm	Aluminium	2400-2700 mm	9 kg
1851	125 x 30 mm	Aluminium	Finish length made to measure	± 9 kg

Art.nr.	Dimension (mm)	Material	Weight	
1852	30 120 110	Steel & Zinc plated	0,3 kg	



SHORING POLES

KARGO KEEPER, spares

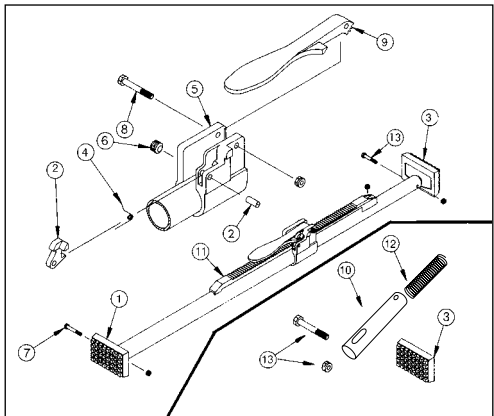

No.	Part no.	Description
1	186701	Large foot
2	186702	Release trigger
3	186703	Small foot (also WS)
4	186704	Spring for housing
5	186705	Housing
5	186705HD	Housing for HD version
6	186706	Housing mounting screw
7	186707	Nut + bolt for foot
8	186708	Nut + bolt for handle
9	186709	Handle
10	186710	Aluminium insert for WS
11	186711	Rack
12	186712	Spring for WS
13	186713	2+4+5+6+8+9+11 mounted
13	186713HD	2+4+5HD+6+8+9+11 mounted

WS = with spring

CARGO-BAR, spares (available on request)

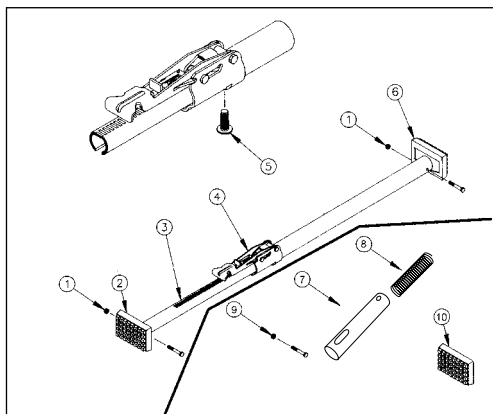

No.	Part number.	Description
1	FE8040-6	Nut + bolt for foot
2	FE8040-24	Small foot
3	FE8040-8	Extension tube
4	FE8040-76	Complete housing
5	FE8040-71	Housing mounting screw
6	186701	Large foot
7	FE8040-10	Aluminium insert for WS
8	FE8040-12	Spring for WS
9	FE8040-13	Nut + bolt for WS
10	186703	Small foot for WS

WS = with spring

